

508

512
514

20

6" Clay To 6" Plastic
Ferro ~ 6.20' Deep

6" Clean Out
6.33' Deep

Hydraulic Cement
7'± To Flow Line

27" Strm.

10" San.
8" San.

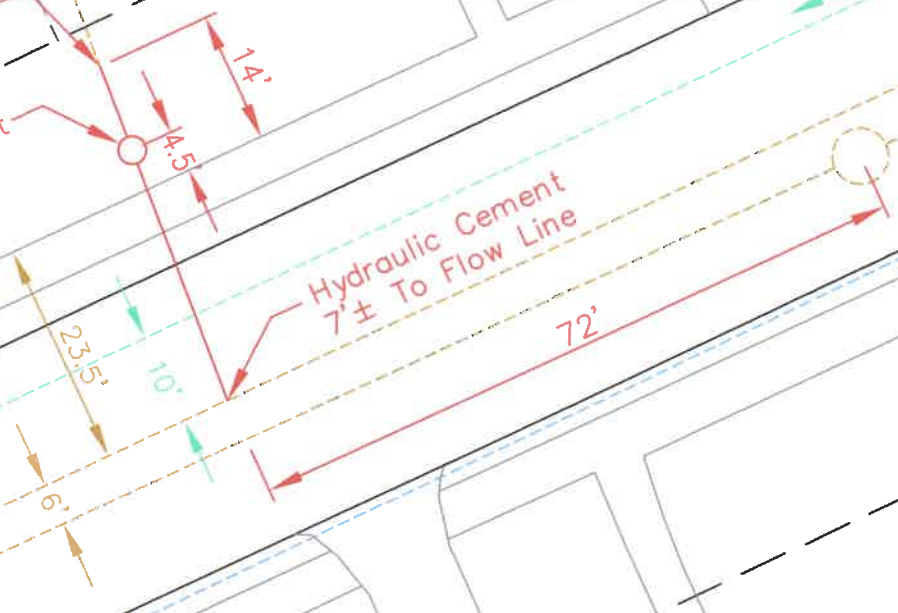

512 & 514 W. Clinton St.
Sanitary Service Replacement
Inspection By Joseph R. Kleiner, P.E.

Created: Sep. 2, 04
Plotted: Sep. 9, 04
Scale: 1:20
Sheet 00 Of 00